



**SeethaRam**  
Mechatronics Pvt Ltd

◀ Bridging Gaps in Technology ▶

# || Vibes || - vibration



## Mobile App User Guide

---

Read the user's manual carefully before starting to use the unit or software.  
Producer reserves the right to implement changes without prior notice.

## Step - 1 Instructions

---

- ✓ Open Vibes configurator app on your Android device. Turn OFF the sensor device and Turn ON the configurator device to pair with the sensor device.

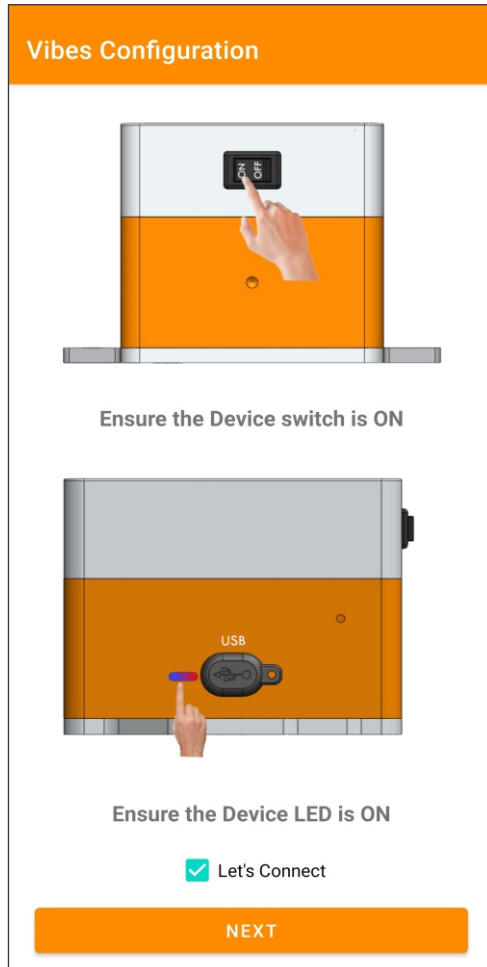

## Step - 2 Device Connection

---

- ✓ Connect your mobile wi-fi with Vibes device and return to the Vibes configuration app and select configure.

### Vibes Configuration

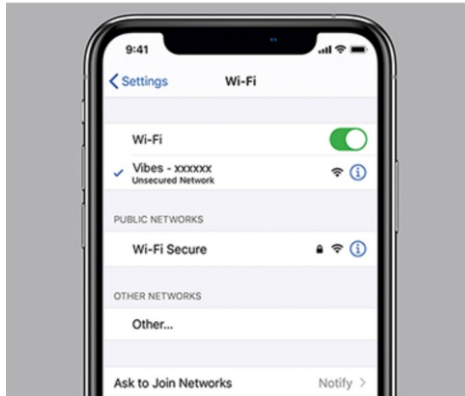

Connect your device to 'Vibes-xxxxxx' and return to the Vibes configuration app  
Default Password: password

SET WIFI

CONFIGURE

## Step - 3 Dashboard

---

- ✓ Here you can monitor device data on local dashboard

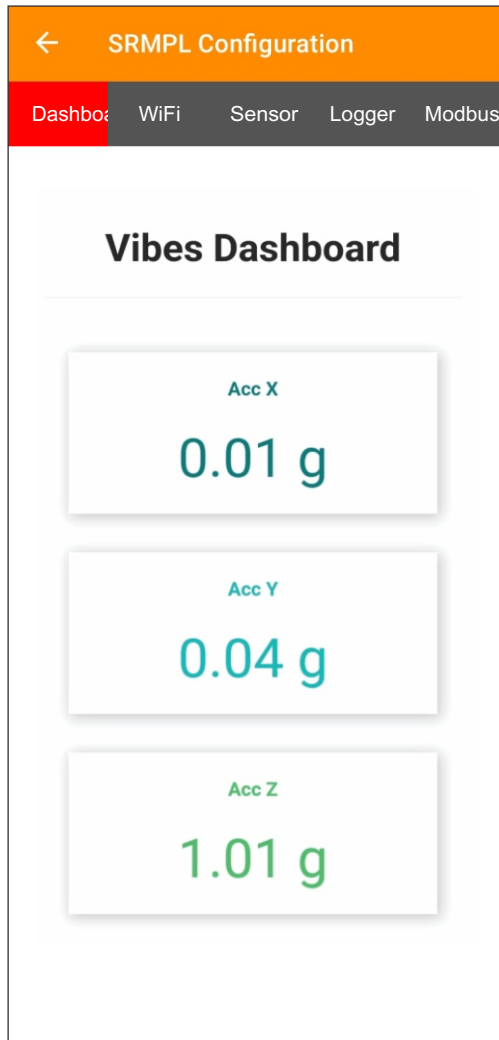

## Step - 4 Wi-Fi & Server Configuration

---

Enter your device SSID credentials & server credentials in Wi-fi credentials to view sensor data on cloud server.

The screenshot shows the SRMPL Configuration app interface. At the top, there is an orange header with a back arrow and the text "SRMPL Configuration". Below this is a dark grey navigation bar with five tabs: "Dashboard", "WiFi", "Sensor", "Logger", and "Modbus". The "WiFi" tab is highlighted in red. The main content area is white and contains two sections: "Wi-Fi Credentials" and "MQTT Settings".

**Wi-Fi Credentials**

SSID  
Enter SSID

Password  
Enter Password

**MQTT Settings**

Server Address  
Server Address

Port  
Port

User name  
User name

## Step - 5 Sensor Configuration

---

Here you can set the range & calibrate the vibration sensor

← SRMPL Configuration

Dashbo: WiFi **Sensor** Logger Modbus

### Sensor Configuration

Select Range +/- 10g

SAVE

Current Set Range : +/- 10 g

**Calibration**

Please Place the device horizontally and then press Calibrate Button.

CALIBRATE

**ZERO**

Please Place the device horizontally and then press Zero Button.

ZERO

## Step - 6 Data Logger Configuration

### Settings

1. Today's Date & Time
2. Logging Interval required (Minimum 1 Minute Interval)

### Data Management

1. Download file by clicking the download button  in CSV format
2. A new file will be generated in mm/yy format every calendar month
3. Delete files after downloading as per your choice. Please note file will be deleted permanently

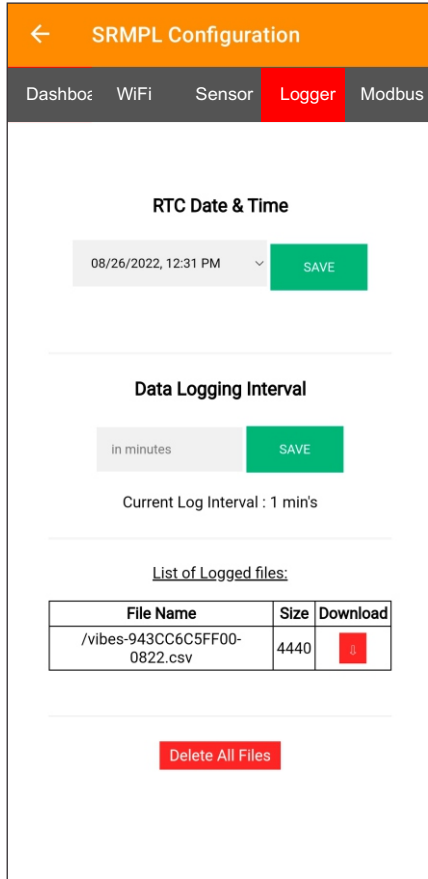

The screenshot shows the SRMPL Configuration page with the following sections:

- RTC Date & Time:** A date and time selector showing "08/26/2022, 12:31 PM" and a green "SAVE" button.
- Data Logging Interval:** A field labeled "in minutes" and a green "SAVE" button. Below it, it says "Current Log Interval : 1 min's".
- List of Logged files:** A table with columns "File Name", "Size", and "Download".

File Name	Size	Download
/vibes-943CC6C5FF00-0822.csv	4440	

At the bottom of the page, there is a red button labeled "Delete All Files".

## Step - 7 Configuration for Modbus Devices

---

Enter Modbus device ID and Baud Rate (only for MODBUS Devices)

← SRMPL Configuration

Dashbo: WiFi Sensor Logger **Modbus**

### RS485-Modbus RTU Parameters

Device ID

BaudRate

**SAVE**

Modbus ID : 10  
BaudRate : 9600