

Force Column Internal Thread (FCIT)

Caution

- Do not pull on or carry sensor by cable.
- Be careful not to apply excessive force on or mount anything in contact of the diaphragm area.
- Any tampering or removal of cover, cable and/ or connector will void warranty.



Do's

Don't's Mounting

Do's

Don't's

1

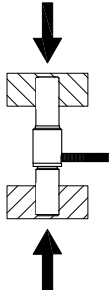

- LOAD MUST BE EVEN, CENTERED AND IN LINE

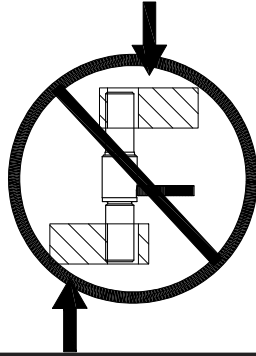

2

- TENSION LOADING MUST BE IN LINE WHEN COMPENSATION LINKAGES ARE NOT USED

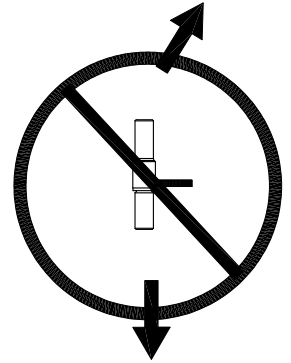
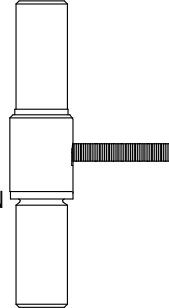

3

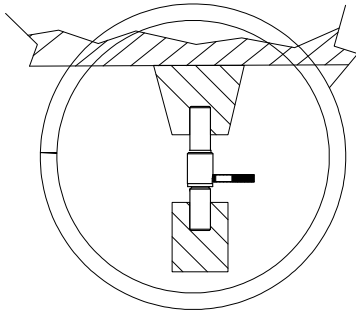

- LOAD MUST BE FLAT AND PARALLEL WHEN COMPENSATING LINKAGES ARE NOT USED

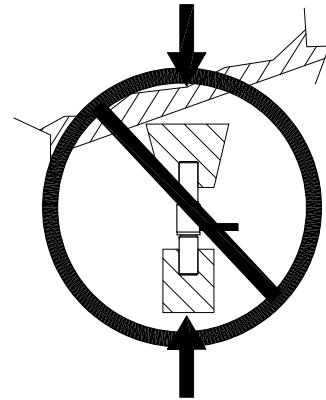

4

- AVOID OR MINIMIZE TORQUE DURING INSTALLATION

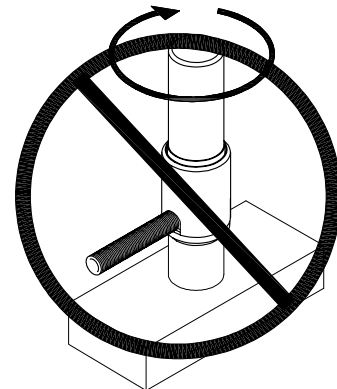
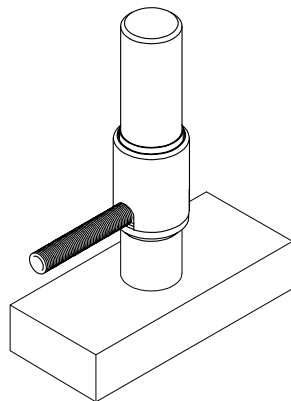

5

- ROD END BEARINGS WITH CLEVISSES OR ALIGNMENT COUPLERS MAY BE USED TO MAKE UP FOR MISALIGNMENT

