

Customized Shear Beam - CSB

Special Type Tension Load Cells

FEATURES

A compact and low cost, shear type compression & Tension load cell. Economic model shear type transducers with a high accuracy. It is used for Automobile Industry, especially used for brake and gear load testing applications.



TECHNICAL SPECIFICATION

Model	CSB
Rated capacity(R.C.)	10kgf
Rated output(R.O.)	2mV/V±0.1%
Nonlinearity	0.03% of R.O.
Hysteresis	0.02% of R.O.
Repeatability	0.02% of R.O.
Creep(20min)	0.03% of R.O.
Zero balance	±5% of R.O.
Temp. effect, on rated output	0.02% of LOAD/10°C
Temp. effect, on zero balance	0.05% of R.O./10°C
Temp. range, compensated	-10~50°C
Temp. range, safe	-20~80°C
Terminal resistance input	350±30Ω
Terminal resistance output	350±3Ω
Insulation resistance bridge	2000MΩ
Excitation recommended	10V (max. excitation 15V)
Safe overload	150% R.C.
Cable length	Ø4 ±0.2mm 4core, 2m

WIRING INFORMATION

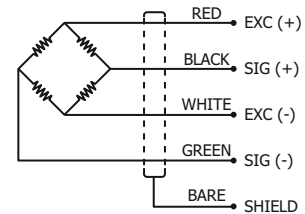

DIMENSION DETAILS

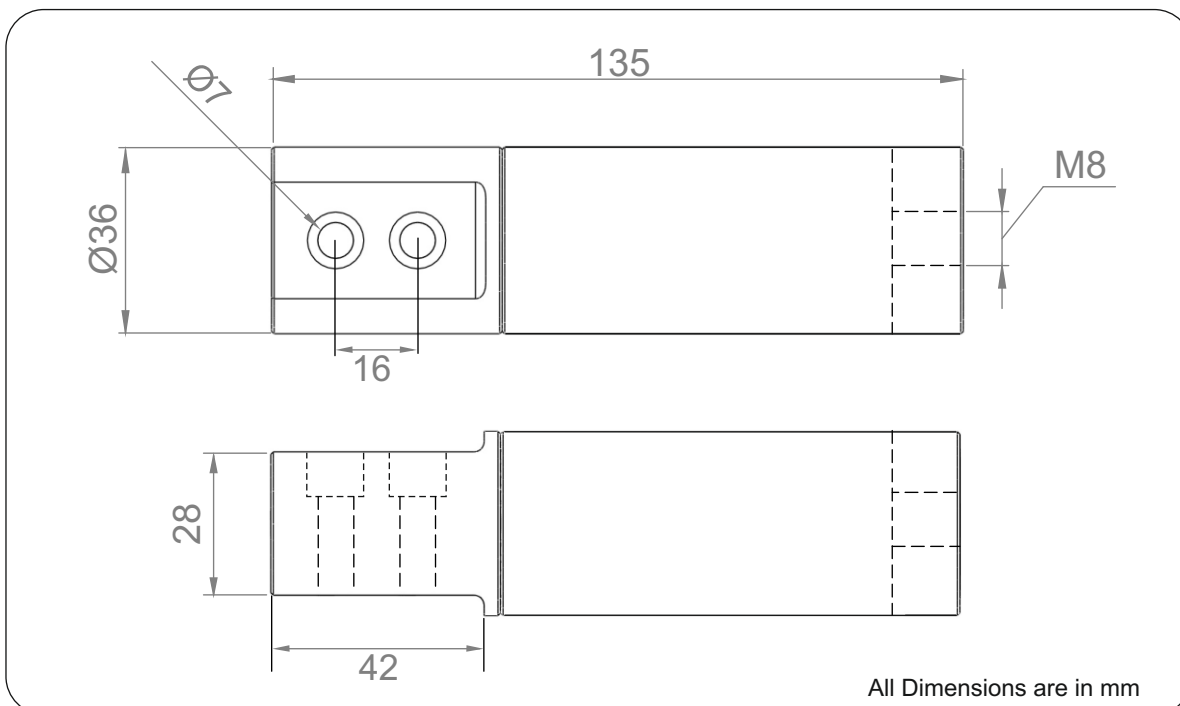

Specifications are subject to change without Prior notice