

## FEATURES

This Probe is meant for industry-proven quality and reliability in measurement of humidity and sensors and constant accuracy over a large measurement range.

The probe uses Capacitive humidity sensor with a bandgap calibration Data memory, D/A converter. The sensor covers a humidity measurement range of 0 to 100 %RH with typical accuracy of  $\pm 2\%$  RH. This Sensor can be used within a temperature range of  $-40^{\circ}\text{C}$  to  $125^{\circ}\text{C}$

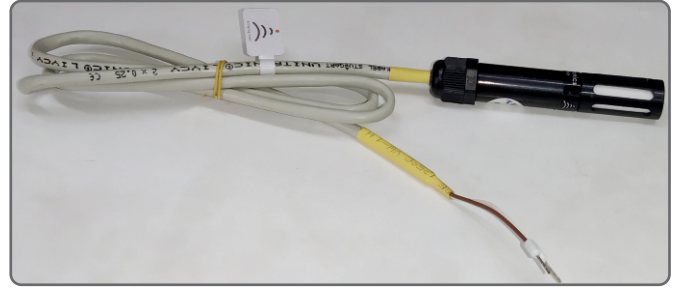

## APPLICATION

Can be used in Industrial Automation in Chemical Plants, Pharma, Engineering industries and commercial applications. The sensor shall be compatible to Indicator Controllers, SCADA, Industry 4.0 standards and IoT compatible.

## TECHNICAL SPECIFICATION

| Model             | ES-H-MC                      |
|-------------------|------------------------------|
| Humidity          | 0% ~ 100% RH                 |
| Accuracy          | $\pm 2\%$ RH, $\pm 0.2\%$ °C |
| Response Time     | $\tau 63\%$ 8 Sec            |
| Cable             | PTFE / 1 Metre               |
| Operating Voltage | 15 ~ 30VDC                   |
| Output            | Humidity: 4~20mA (2 wire)    |
| Housing           | Aluminium Grade 6xxx series  |
| Filter            | PTFE Sintered Porous Filter  |

| Parameter          | Condition   | Value       | Unit  |
|--------------------|-------------|-------------|-------|
| Accuracy tolerance | Typ.        | $\pm 2.0$   | %RH   |
|                    | Max.        | Below Graph | %RH   |
| Repeatability      | -           | 0.1         | %RH   |
| Resolution         | -           | 0.01        | %RH   |
| Hysteresis         | -           | $\pm 1$     | %RH   |
| Specified range    | extended    | 0 to 100    | %RH   |
| Response time      | $\tau 63\%$ | 8           | S     |
| Long-term drift    | Typ.        | $< 0.25$    | %RH/y |

## DIMENSION DETAILS

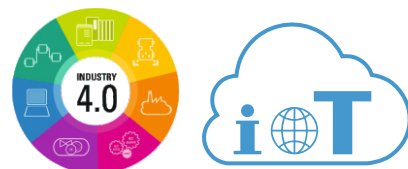
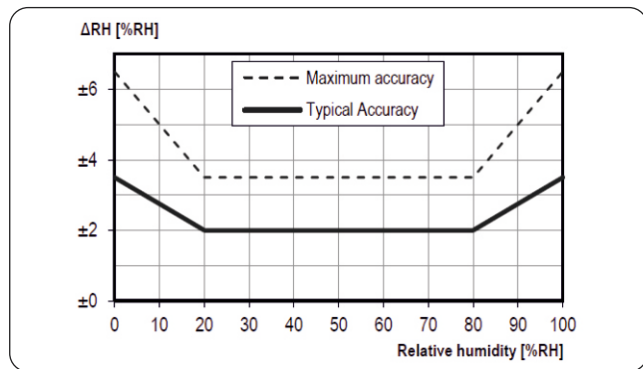
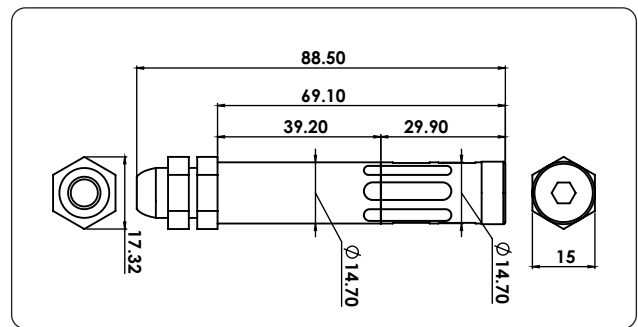

Compatible

## Also Available

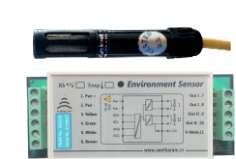

Discrete

Probe & Electronics  
Current Output - Rh & Temperature



Display Logger

Rh, Temperature,  
eCo2 & Barometric Pressure



Koal Touch

Input Signal - Strain Gauge,  
Potentiometer, Pressure &  
Other Amplified Sensors

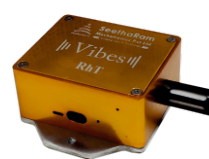

Vibes RhT

IoT - Rh &  
Temperature

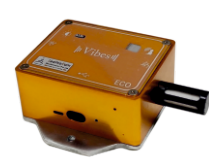

Vibes Eco

IoT - Rh, Temperature,  
Lux & Occupancy

Specifications are subject to change without Prior notice